

Code:

HC2600CLWH

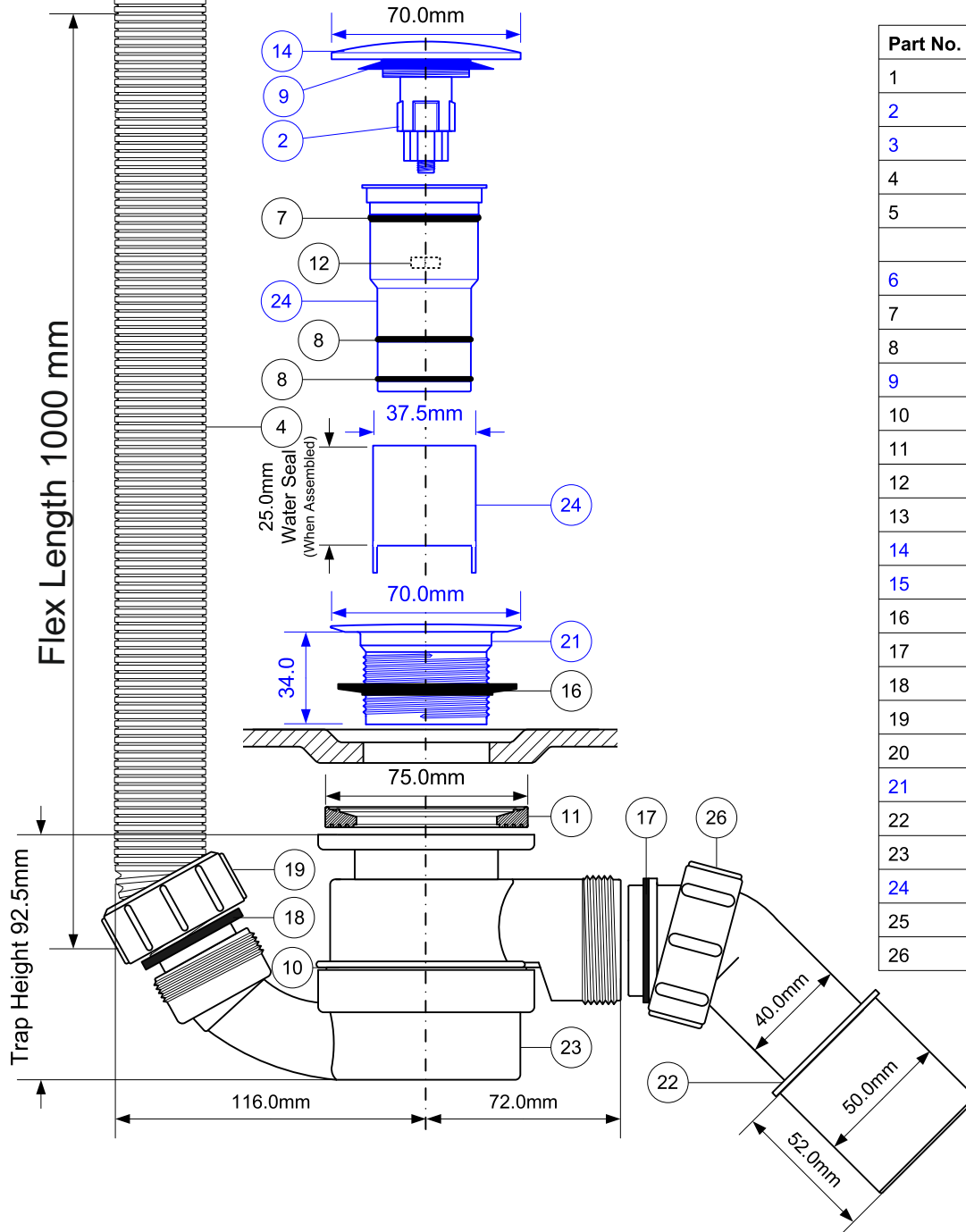
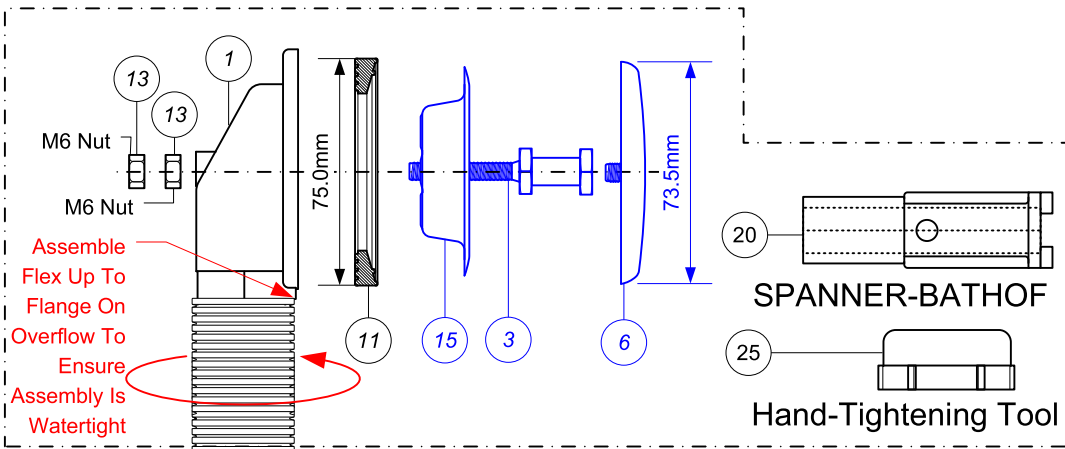

| Part No. | Code |
|----------|---|
| 1 | BATHROSE-SLIM |
| 2 | CLICCKERSWITCHHB |
| 3 | FERRULE-BH |
| 4 | FLEXBATH-27.5 |
| 5 | P-BS245X530HMC (Plastic Bag – Not shown) |
| 6 | P-CPB-OF-COVER |
| 7 | P-OR-037.00-1.50 |
| 8 | P-OR-HC26 |
| 9 | P-RW-CLICKSEAL |
| 10 | P-RW-NEWBOTTLE |
| 11 | P-RWNEWSTW7.5 |
| 12 | P-1/4UNC-INSERT |
| 13 | P-SS-6MMHEXNUT |
| 14 | P-SS-CHKC70 |
| 15 | P-SS-GRID-HC30 |
| 16 | RW-HC31SEAL |
| 17 | RW2 |
| 18 | S13-NITRILE |
| 19 | S8B |
| 20 | SPANNER-BATHOF |
| 21 | STW70CPB-NG |
| 22 | STWBENDBODY-50 |
| 23 | STWHC2600BODY |
| 24 | STWHC26TUBE |
| 25 | STWSPANNER |
| 26 | T8A |

Drawing verified correct as of:

| | | |
|----------|---------|------------|
| DRAWN BY | REVISED | FILENAME |
| | | HC2600CLWH |
| | SCALE | DATE |